

RECEIVED
FEB 23 2015
KITITAS COUNTY
CDS

C/L 4TH PAR.

C/L DENMARK RD

S 02°51'48" E
865.66'

S 59°11'36" W
165.80'

30.3'

23.6'

19.8'

N 05°30'57" E
181.56'

N 03°43'23" E
102.01'

24.7'

S 14°58'36" W
86.61'

S 02°27'00" W
153.96'

S 01°54'50" E
109.40'

S 01°34'55" W
81.86'

S 31°08'16" W
82.04'

3.79 AC
2

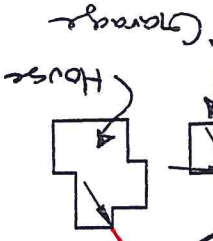
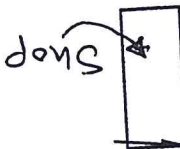

279.73'
S 89°38'46" W